

## Chamfered Square Nut

**Thread Type:** Metric - Coarse

**Thread Direction:** Right Hand

**Material:** Stainless Steel

**Class Grade:** A4-70 G316

**Corrosion Protection Level:** Ultimate

**Standard:** DIN 557

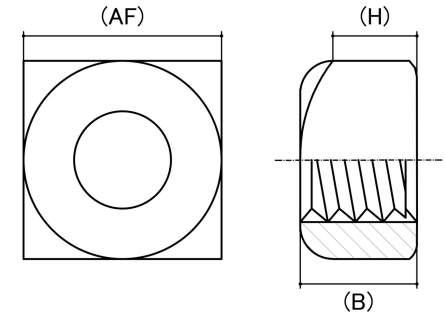

*CAD drawings shown for graphic representation only.\**

| Size | Thread Pitch (mm) | Thread Type | Overall Nut Height (B) (mm) |       | Hex Height (H) (mm) | Across Flats (AF) (mm) |       | Spanner Size (AF) (mm) | sku (qfind) |
|------|-------------------|-------------|-----------------------------|-------|---------------------|------------------------|-------|------------------------|-------------|
|      |                   |             | Min                         | Max   | Nom                 | Min                    | Max   |                        |             |
| M5   | 0.80              | Coarse      | 3.52                        | 4.00  | -                   | 7.57                   | 8.00  | 8                      | 41SQS5M     |
| M6   | 1.00              | Coarse      | 4.52                        | 5.00  | -                   | 9.64                   | 10.00 | 10                     | 41SQS6M     |
| M8   | 1.25              | Coarse      | 5.92                        | 6.50  | -                   | 12.57                  | 13.00 | 13                     | 41SQS8M     |
| M10  | 1.50              | Coarse      | 7.42                        | 8.00  | 5.20                | 16.57                  | 17.00 | 17                     | 41SQS10M    |
| M12  | 1.75              | Coarse      | 9.42                        | 10.00 | 6.60                | 18.48                  | 19.00 | 19                     | 41SQS12M    |
| M16  | 2.00              | Coarse      | 12.30                       | 13.00 | 8.60                | 23.16                  | 24.00 | 24                     | 41SQS16M    |

**Disclaimer:**

Dimensional data and technical information was obtained from publicly available sources and not acquired through standard agencies. It has been completed and compiled for reference purposes only; where discrepancies are found they are subject to change without notice. Bolt & Nut Australia makes no warranties or representations regarding the accuracy and validity of the compiled information and data. Contact the relevant standard authorities for accurate and detailed information.

\* CAD drawings may not reflect diameter, thread length or overall length.

© Bolt & Nut Australia Pty Ltd. All rights reserved.

Version: 18 Mar 2024